

TRACT 1:
 A tract of land being part of the Southwest Quarter of Section 30, Township 50 North, Range 6 West of the fifth principal meridian, Montgomery County, Missouri being more particularly described as follows:
 Beginning at an iron rod marking the Southeast corner of the Southwest Quarter of said Section 30; thence along the South line of said Section 30, North 87 degrees 48 minutes 48 seconds West, a distance of 323.84 feet to an iron rod; thence North 03 degrees 20 minutes 23 seconds East, a distance of 895.57 feet to an iron rod on the West line of the Southeast Quarter of said Southwest Quarter; thence North 03 degrees 12 minutes 04 seconds East, a distance of 433.91 feet to an iron rod marking the Northwest corner of the Southeast Quarter of said Southwest Quarter; thence North 45 degrees 12 minutes 48 seconds East, a distance of 929.04 feet to an iron rod; thence North 03 degrees 09 minutes 08 seconds East, a distance of 644.50 feet to the North line of said Southwest Quarter; thence South 87 degrees 46 minutes 40 seconds East, a distance of 671.62 feet to a point at the Northeast corner of said Southwest Quarter being 20.00 feet North 03 degrees 09 minutes 08 seconds East of an iron rod; thence South 03 degrees 09 minutes 08 seconds West, a distance of 2652.27 feet to the POINT OF BEGINNING containing 44.3 acres. Subject to that part currently being used for public roadway.

- - FOUND IRON PIN
- ⊗ - FOUND STONE
- ⊠ - RIGHT-OF-WAY MARKER
- ⊙ - 5/8" REBAR W/PLS 2005000079 CAP
- (M) - MEASURED
- (R) - RECORD
- (D) - DEED
- (GLO) - ORIGINAL GLO DISTANCE

0 400 800

1 INCH = 400 FEET

BEARINGS ARE MISSOURI CENTRAL GRID BASED ON GPS OBSERVATION

CLIENT: ERIC BOSCHERT
 DATE OF SURVEY: MAY 2, 2023
 ACCURACY CLASS: RURAL PROPERTY

ALL DISTANCES AND AREAS SHOWN ARE BASED ON GROUND MEASUREMENTS. PROJECT SCALE FACTOR FOR MISSOURI CENTRAL GRID NAD 83 IS 1.00001543.

FIELD: MGW	DRAWN: WJS	PROJECT #23-137
SURVEY CERTIFICATE OF AUTHORITY LS-2009021550		

SCHAEFER SURVEYING, LLC

John H. Schaefer, PLS 30638 Kenbrook Pl. Macon, MO 63552
 PHONE: 660-395-5942
 EMAIL: john@schaefersurveying.com

BOUNDARY SURVEY

SW 1/4, SEC 30, T50N, R6W
 MONTGOMERY COUNTY, MISSOURI

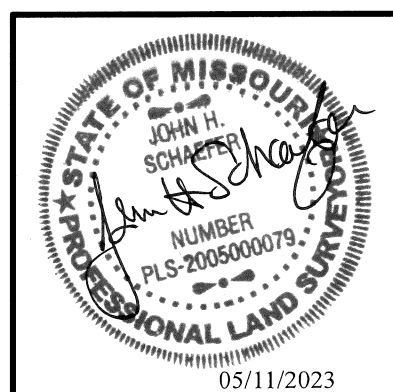

TRACT 2:
 A tract of land being part of the Southwest Quarter of Section 30, Township 50 North, Range 6 West of the fifth principal meridian, Montgomery County, Missouri being more particularly described as follows:
 Beginning at an iron rod marking the Northwest corner of the Southwest Quarter of said Section 30; thence along the North line of said Southwest Quarter, South 87 degrees 46 minutes 40 seconds East, a distance of 1925.25 feet to an iron rod; thence South 03 degrees 09 minutes 08 seconds West, a distance of 644.50 feet to an iron rod; thence South 45 degrees 12 minutes 48 seconds West, a distance of 929.04 feet to an iron rod marking the Southeast corner of the Northwest Quarter of said Southwest Quarter; thence North 87 degrees 55 minutes 59 seconds West, a distance of 1299.19 feet to an iron rod marking the Southwest corner of the Northwest Quarter of said Southwest Quarter; thence North 02 degrees 59 minutes 40 seconds East, a distance of 1327.60 feet to the POINT OF BEGINNING containing 54.2 acres. Subject to that part currently being used for public roadway.

SURVEYORS STATEMENT
 A survey of the property shown hereon has been performed to the best of my knowledge and belief in accordance with the current Missouri Standards for Property Boundary Surveys.

John H. Schaefer,
 Missouri P.L.S.#2005000079

- REFERENCE SURVEYS:**
- 1985; DOC #750-22543; BADE, PLS #1434
 - 2016; BK D, PG 205; WALKER, PLS #2014000200