

Aerial Map

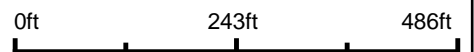

©2017 AgriData, Inc.

map center: 38.983709, -92.897071



TROPHY
PROPERTIES AND AUCTION
LAND (RECREATIONAL) RESIDENTIAL

Maps Provided By:



© AgriData, Inc. 2017

www.AgriDataInc.com

28-49N-18W
Cooper County
Missouri

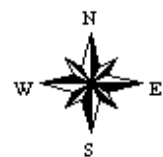

11/6/2017

Soils Map

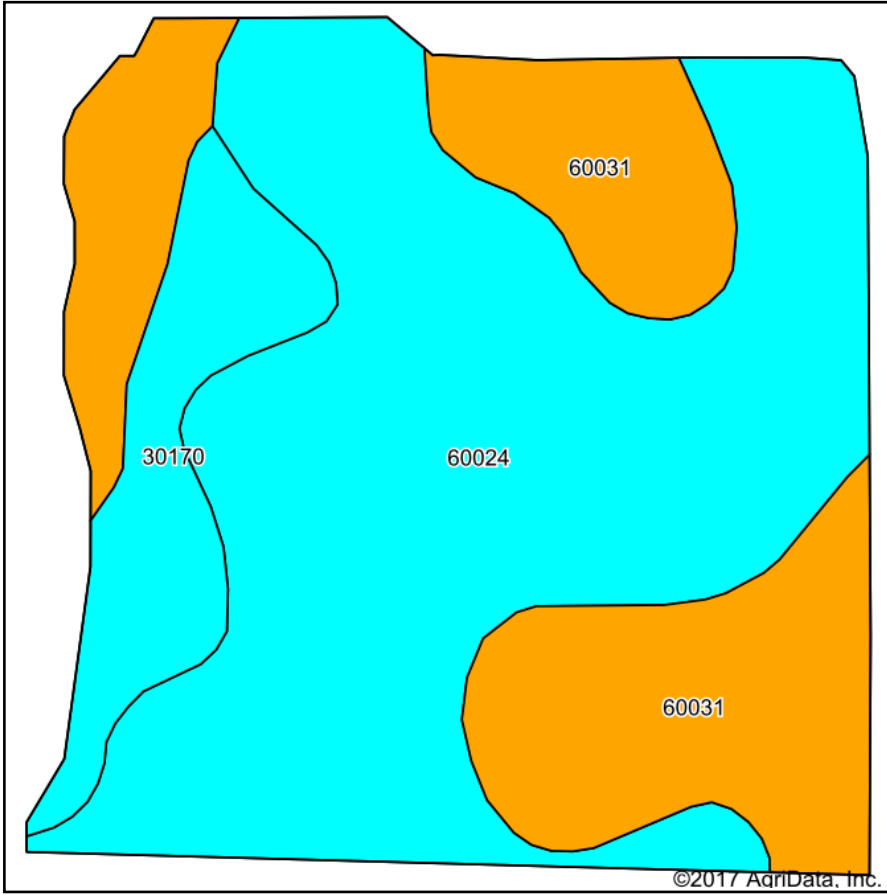

Soils data provided by USDA and NRCS.

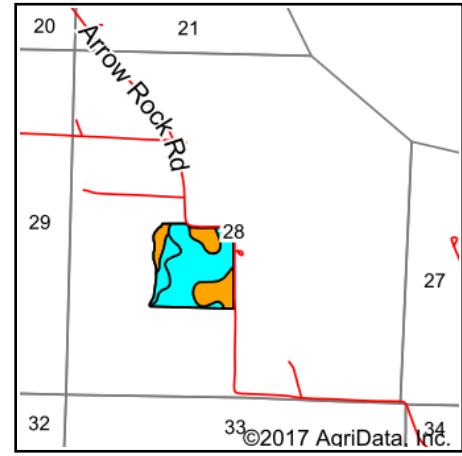

State: **Missouri**
 County: **Cooper**
 Location: **28-49N-18W**
 Township: **Lamine**
 Acres: **36.04**
 Date: **11/6/2017**



TROPHY
 PROPERTIES AND AUCTION
 LAND, INDUSTRIAL, RESIDENTIAL

Maps Provided By:



© AgriData, Inc. 2017

www.AgriDataInc.com



Area Symbol: MO053. Soil Area Version: 19

Code	Soil Description	Acres	Percent of field	Non-Irr Class Legend	Non-Irr Class *c
60024	Menfro silt loam, 3 to 9 percent slopes, eroded	21.21	58.9%		IIIe
60031	Winfield silt loam, 9 to 14 percent slopes, eroded	11.06	30.7%		VIe
30170	Pershing silt loam, 5 to 9 percent slopes, eroded	3.77	10.5%		IIIe

*c: Using Capabilities Class Dominant Condition Aggregation Method

Soils data provided by USDA and NRCS.